

Plantronics Part Number List with Photographs and Sources

DECT 6.0 Technology for *USA* Market Place (Models CS 520 and SAVI W720)

DECT Technology for *Non-USA* Market Place (Model SAVI W720 DECT)

NOTICE

All Photographs, materials, manufacturers, and model/part numbers were derived from manufacturers' user manuals, web sites and vendor web pages. There is no implied warranty that the information present is free from error and the user of this information should validate its accuracy and usage in their intended applications. Price Class information was derived from commercial vendor web pages and alternate sources may offer lower pricing at the expense of quality/non-branded/refurbished or previously used materials. This information will be updated when new information is known.

Prepared by
Gene Hinkle, K5PA

Original on 7/13/2017
Updated on 11/25/2020
Updated on 03/29/2022

<https://www.cs520hams.k5pa.com>

CS520 Wireless Headset

Complete: Plantronics P/N 84692-01

P/N 86920-01
Model WH350
Binaural Headset
(2 Ear Pieces w/Mono
Sound)

- **DECT 6.0**
- 1900 MHz Band
- Encrypted

CO52 Base Unit

Telephone Interface
Cable



P/N 83648-01
Model SSA-5W 090050
9 VDC, 500 mA Power Supply



FactoryOutletStore.com
An Independent Retailer Of Consumer Products

plantronics.

Authorized Partner

Price Class: \$50 - \$200 ea.

CS510-XD / CS520-XD

(Non Compatible)

XD Models Are 900 MHz Band Only. Not Compatible with CS520.



Plantronics **CS510-XD**
Monaural Over The Ear
P/N 88284-01

NOT USED



Plantronics **CS520-XD**
Binaural Wireless Headset
P/N 88285-01

NOT USED

DECT Technology for the Non-USA Market Places

(Also, See Next Page for SAVI W720)

DECT Versus DECT 6.0 (USA Marketplace)

The DECT 6.0 is for USA markets to meet FCC requirements for 1.9 GHz operation. For non-USA markets the proper wireless headset should be chosen. For example, in New Zealand, a search for which headsets are used in local telemarketing centers would be one source of information.

I have searched from other web pages for non-USA headsets and found the **SAVI W720, Over the Ear, Monaural Standard**, headset to be one that meets the DECT requirement (not 6.0) and therefore *might* be a good choice to consider. It appears to have similar specifications to the Plantronics CS520.

Disclaimer: I have not interfaced to any other headset for use outside the USA so this is something that can be tried by some enterprising ham radio operator.

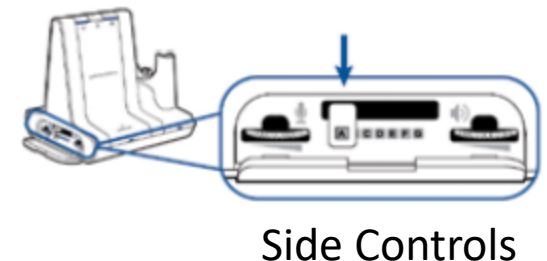

The SAVI W720 Headset System with DECT 6.0 Technology for the USA Market Places

WO2 Base Unit for W720 With DECT 6.0 (USA Marketplace)

The DECT 6.0 is for USA markets to meet FCC requirements for 1.9 GHz operation. We have searched headsets and found the **SAVI W720 with DECT 6.0, Over the Ear, Binaural Standard**, headset to be one that meets the DECT 6.0 and appears to have similar specifications to the Plantronics CS 520.

WB2REM and I have since purchased the **WO2 Base Unit** for the W720 on ebay and found them to be 100% compatible with the CS 520 headset also!

The benefit to using the W720 (that uses the WO2 Base Unit) is that it provides a user selectable interface to 1) Bluetooth devices (e.g., cell phones), 2) Personal Computers via a built-in sound interface, and the normal 3) RJ45 phone interface (that we have commandeered for our ham radio audio interfaces).

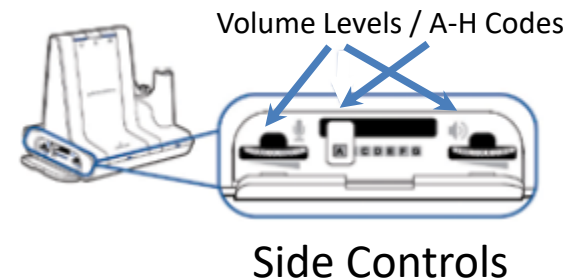

The SAVI W720 Headset System for the USA Market Places

WO2 Base Unit With Headset Charger Cup

The WO2 base unit must be purchased with the correct headset cup so it can be charged when in the cradle. The photograph shows how the W720 should appear when it has the **correct cradle attached already**.

If you find a WO2 base that has a different headset charging cradle, it can be snapped off and the proper one snapped in its place. Preferably, you should buy the correct WO2 unit with the correct cradle already installed for the binaural (2-ear) headset as shown in the figure.

If you wanted to replace your existing cradle, the headset cup is Plantronics P/N 83776-11 and can be snapped in place in the WO2 base. It can be purchased separately from ebay or the Plantronics Outlet Store.



This is Plantronics P/N 83776-11 Prior to Snapping onto the Base Unit.



FactoryOutletStore.com
An Independent Retailer Of Consumer Products

plantronics.

Authorized Partner

Price Class: \$50 - \$200 ea.

Rev-B

Boom Mic Windscreen (Add-on Accessory)

Manufacturer: eBoot

Vendor: Amazon

Model No.: eBoot

ASIN: B01EJ0N5FS

Description:

Lapel Mic Windscreen

Specs:

- Outside Diameter: 0.87"
- Inside Diameter: 0.31"
- Long: 1.06"
- Color: Black
- Manufacturer: eBoot



Source

amazon

Click Image

Price Class: \$5, for Qty 5

WH350 Replacement Headset

REPLACEMENT HEADSET:

DESCRIPTION: SPARE, WH350, BIN OTH, HEADSET, DECT 6.0, CS 520

PART NUMBER (P/N): 86920-01 **(Just the Spare Headset P/N)**

Price Class: \$125 ea.



BASE CHARGE UNIT: **(This is a charging base only, need power supply module!)**

DESCRIPTION: Charging Cradle 83776-01 for Savi WH300 and Plantronics WH350 Headset

PART NUMBER (P/N): 83776-01

Price Class: \$20 ea.



Source

FactoryOutletStore.com
An Independent Retailer Of Consumer Products

plantronics.

Authorized Partner

Plantronics Universal AC Power Supply (Replacement)

Power Supply

Replacement

Product P/N: 81423-01

Replaces Factory P/N: 83648-01

Model SSA-5W 090050

9 VDC, 500 mA Power Supply

Barrel Connector

- Center Pin (+)
- Sleeve (-)



Source

FactoryOutletStore.com

An Independent Retailer Of Consumer Products

plantronics.

Authorized Partner

Price Class: \$27 ea.

Plantronics Spare Battery 64399-03 with Removal Tool

With Plantronics Battery Tool 64399-03

Replacement Battery Pack

Product P/N: 64399-03

Li-ion Polymer

3.75V, 190mAh

Comes with Removal Tool



Source

FactoryOutletStore.com
An Independent Retailer Of Consumer Products

plantronics.

Authorized Partner

Price Class: \$40 ea.

Plantronics Spare Battery 64399-03

How to Remove Battery

Procedure

Savi Office W0300 & W0350 Battery Replacement

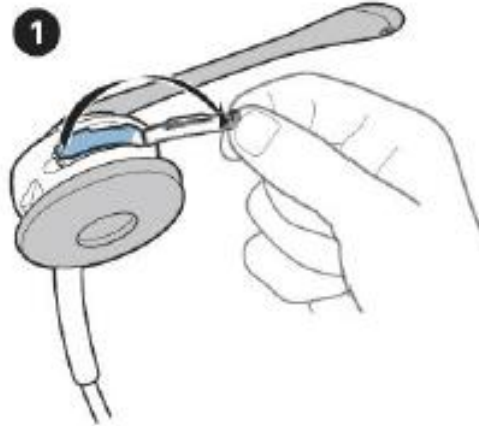

Use a fingernail

to lift off and flip open the battery door.

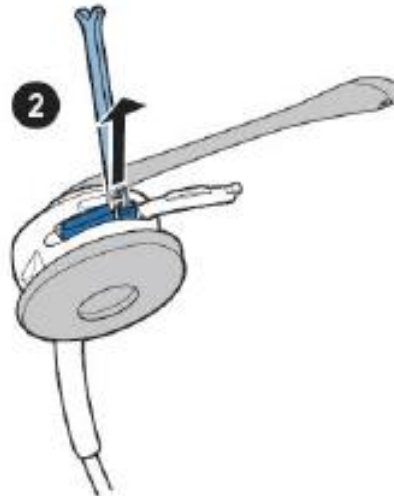

Use the hook end of the tool to hook the battery wires and pull them toward the open battery door until the battery moves out from behind the post.

Plantronics Spare Battery 64399-03

How to Remove Battery

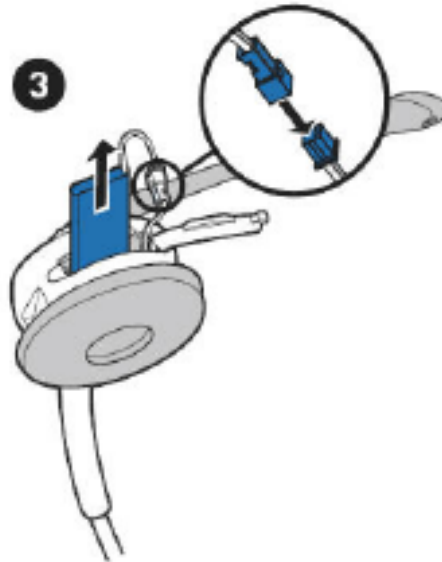

Once the battery is removed, gently disconnect the battery connector;

do not pull hard.



Close the door so that it is flush with the headset.

Plantronics Spare Battery 64399-03

How to Replace Battery

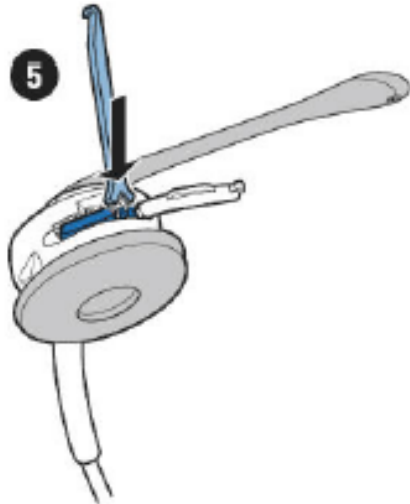

Using the "Y" end of the tool, press the battery backwards

and away from the battery door until the left corner of the battery tucks under the post in the battery compartment. Tuck all of the

battery wires and connectors into the battery compartment

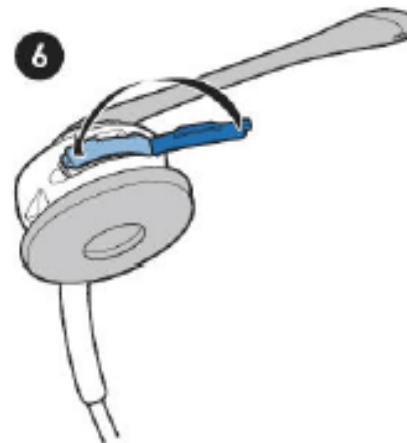

6 - Close the door so that it

Plantronics Headband (Replacement)

Headband for CS520

Product P/N: 72742-02



Source

FactoryOutletStore.com
An Independent Retailer Of Consumer Products

plantronics.

Authorized Partner

Price Class: \$13 ea.

Plantronics Leatherette Ear Cushions

(Replacement Ear Cushions for Headsets)

Plantronics P/N: 71782-01

Pair of black leatherette ear cushions



Part Numbers for Replacement Cushions

71781-01 - Foam

71782-01 – Leatherette

Clip is part of the headphone assembly. Do not discard.
The clip P/N is unknown but has been located on eBay.

Source

FactoryOutletStore.com
An Independent Retailer Of Consumer Products

plantronics.

Authorized Partner

Clip Price Class: \$20 ea.

Cushion Price Class: \$10/Pair

Clip



Cushion



Plantronics Leatherette Ear Cushions

(How to Replace Ear Cushions for Headsets)

How to Replace the Ear Cushions



1. Pull the ear cushion and clip away from the speaker.
2. Pull the ear cushion over the side of the clip.
3. Discard the ear cushion, but be sure to save the clip to reuse with your replacement cushion.

Source

FactoryOutletStore.com

An Independent Retailer Of Consumer Products

plantronics.

Authorized Partner

Plantronics HL10 Lifter

HL10™ Lifter Automatically lifts handset and returns it to the cradle.
Enables remote call answer/end with your headset

- Product # 60961-32 (60961-28 OLD)
- Handset Lifter
- Automatically Lifts Handset & Returns It to Cradle
- Enables Remote / One-Touch Controls (w/ Plantronics Headset)
- Quick & Quiet Operation
- Compatible w/ Most Desktop Phones
- No Desktop Footprint



HL10 Handset Lifter Accessory

USER GUIDE

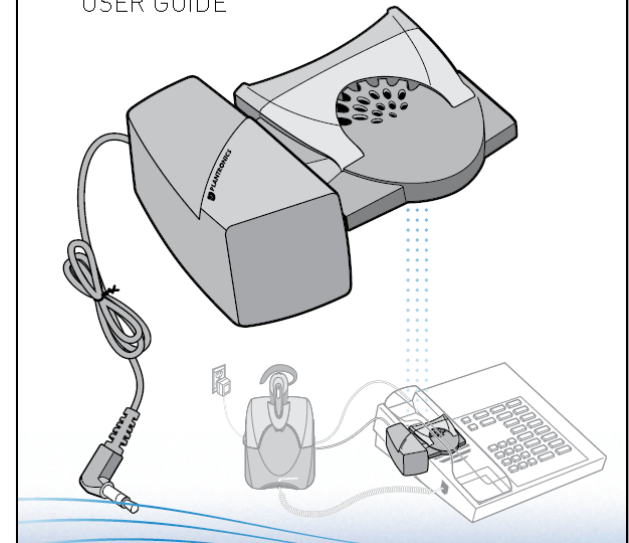

Source

FactoryOutletStore.com

An Independent Retailer Of Consumer Products

plantronics.

Authorized Partner

Price Class: \$50 ea.

Plantronics EHS Cable

Electronic Hookswitch Cable (EHS) Electronically takes your desk phone handset off hook.

Enables remote call answer/end with your headset.

Model: APP-51

Product P/N: 38439-11



Source

FactoryOutletStore.com
An Independent Retailer Of Consumer Products

plantronics.

Authorized Partner

Price Class: \$70 ea.